

12.80



enkelvoudig mechanical seal,
gebalanceerd, voorzien van o'ring afdichting, draairichting onafhankelijk
diameter van 18 mm tot 100 mm

p= 25 bar/ 360 PSI

V= 20 m/sec

t= -50°C +220°C/ -58 F + 430 F

Roterend deel = kool/ siliciumcarbide

Secundaire afdichtingen = NBR, EPDM, Viton, FEP, Kalrez

Veer = rvs 316,

overige delen = rvs 316

overige materialen = op aanvraag

A.T.H. Maintenance B.V.

Vestigingsadres: Antennestraat 39, 1322 AH Almere

Correspondentieadres: Postbus 60007, 1320 AA Almere

Tel: +31 (0)36-535.8700 - Fax: +31 (0)36-535.0299

e-mail: info@atholland.nl - website: www.pomp.nl

K.V.K. Almere 30130719 - BTW nummer NL 8044.68.515.B01

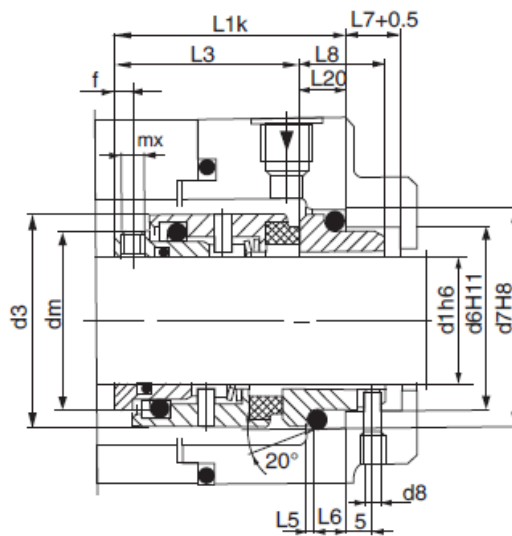

Seal Size														
d1	d3	d6	d7	d8	dm	L1k	L3	L5	L6	L7	L8	L20	F1	MX
18	32	27	33	3	26,0	37,5	30,5	2,0	5,0	9	15,0	7,0	3,0	M4
20	34	29	35	3	28,0	37,5	30,5	2,0	5,0	9	15,0	7,0	3,0	M4
22	36	31	37	3	30,0	37,5	30,5	2,0	5,0	9	15,0	7,0	3,0	M4
24	38	33	39	3	32,5	40,0	33,0	2,0	5,0	9	15,0	7,0	3,5	M5
25	39	34	40	3	33,5	40,0	33,0	2,0	5,0	9	15,0	7,0	3,5	M5
28	42	37	43	3	36,5	42,5	35,5	2,0	5,0	9	15,0	7,0	3,5	M5
30	44	39	45	3	38,5	42,5	35,5	2,0	5,0	9	15,0	7,0	3,5	M5
32	47	42	48	3	41,5	42,5	35,5	2,0	5,0	9	15,0	7,0	3,5	M5
33	47	42	48	3	41,5	42,5	35,5	2,0	5,0	9	15,0	7,0	3,5	M5
35	49	44	50	3	43,5	42,5	35,5	2,0	5,0	9	15,0	7,0	3,5	M5
38	54	49	56	4	47,5	45,0	37,0	2,0	6,0	9	16,0	8,0	4,0	M5
40	56	51	58	4	49,5	45,0	37,0	2,0	6,0	9	16,0	8,0	4,0	M5
43	59	54	61	4	52,5	45,0	37,0	2,0	6,0	9	16,0	8,0	4,0	M5
45	61	56	63	4	54,5	45,0	37,0	2,0	6,0	9	16,0	8,0	4,0	M5
48	64	59	66	4	57,5	45,0	37,0	2,0	6,0	9	16,0	8,0	4,0	M5
50	66	62	70	4	59,5	47,5	38,0	2,5	6,0	9	17,0	9,5	4,5	M6
53	69	65	73	4	62,5	47,5	38,0	2,5	6,0	9	17,0	9,5	4,5	M6
55	71	67	75	4	64,5	47,5	38,0	2,5	6,0	9	17,0	9,5	4,5	M6
58	78	70	78	4	68,5	52,5	42,0	2,5	6,0	9	18,0	10,5	4,5	M6
60	80	72	80	4	70,5	52,5	42,0	2,5	6,0	9	18,0	10,5	4,5	M6
63	83	75	83	4	73,5	52,5	42,0	2,5	6,0	9	18,0	10,5	4,5	M6
65	85	77	85	4	75,5	52,5	42,0	2,5	6,0	9	18,0	10,5	4,5	M6
68	88	81	90	4	78,5	52,5	41,5	2,5	7,0	9	18,5	11,0	4,5	M6
70	90	83	92	4	80,5	60,0	48,5	2,5	7,0	9	19,0	11,5	5,0	M6
75	99	88	97	4	89,0	60,0	48,5	2,5	7,0	9	19,0	11,5	5,5	M8
80	104	95	105	4	94,0	60,0	48,5	3,0	7,0	9	19,0	11,5	5,5	M8
85	109	100	110	4	99,0	60,0	48,5	3,0	7,0	9	20,5	11,5	5,5	M8
90	114	105	115	4	104,0	65,0	65,0	3,0	7,0	9	20,5	13,0	5,5	M8
95	119	110	120	4	109,0	65,0	65,0	3,0	7,0	9	20,5	13,0	5,5	M8
100	124	115	125	4	114,0	65,0	65,0	3,0	7,0	9	20,5	13,0	5,5	M8